

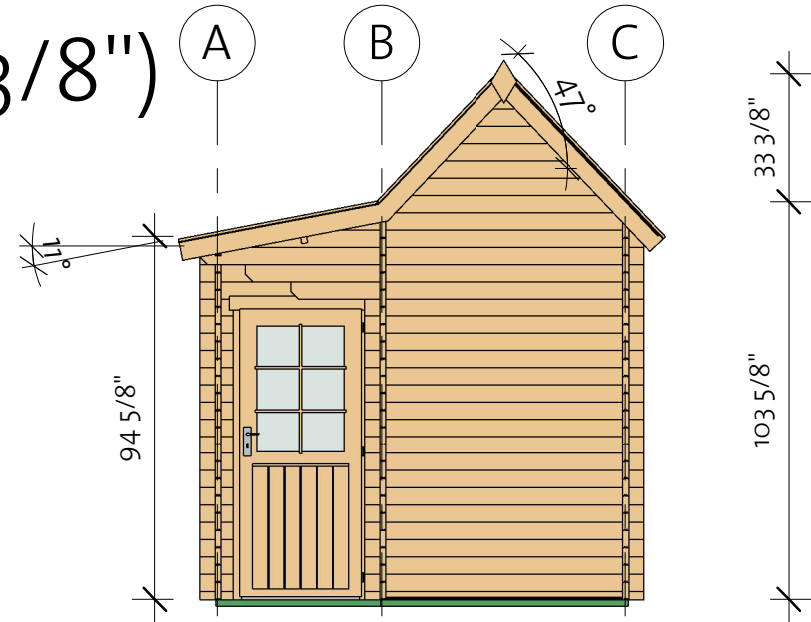

# Laker Shed 40 (107 7/8" x 176 3/8")

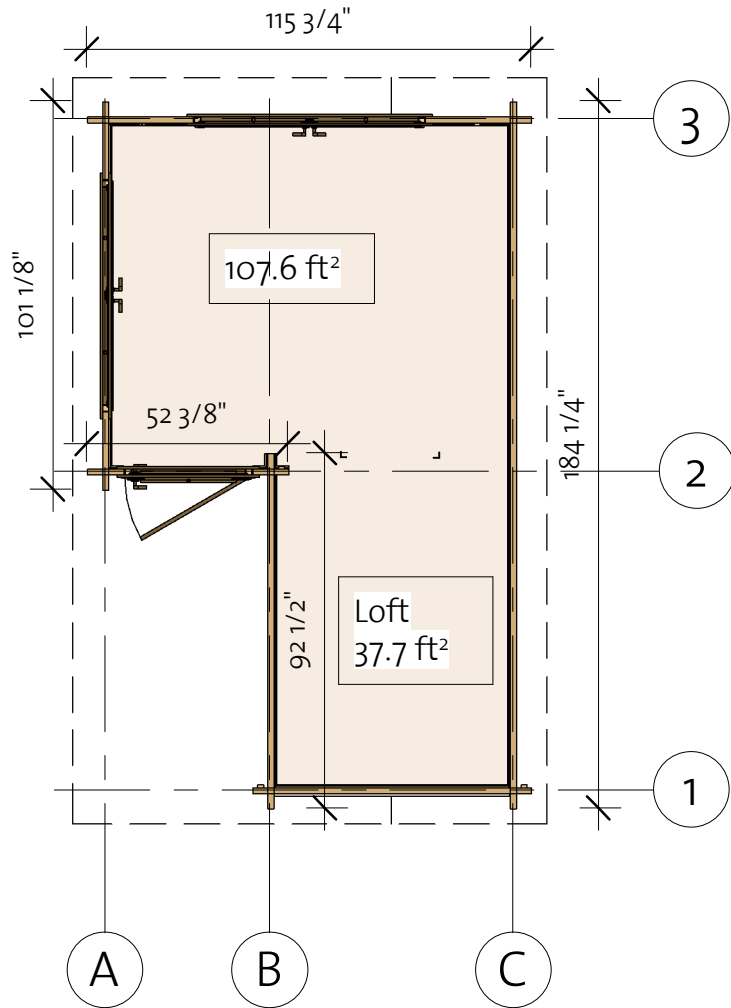
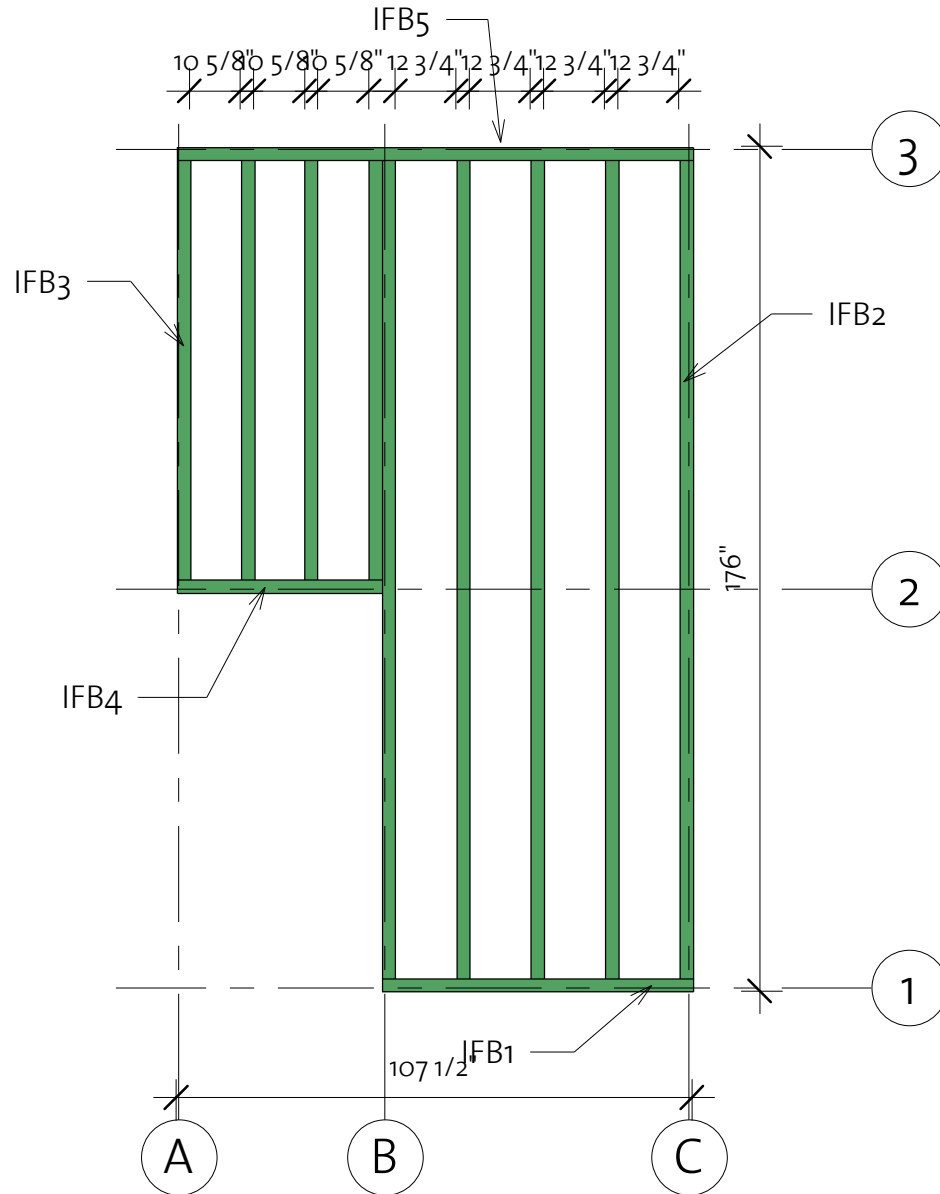

# Laker Shed 40 (107 7/8" x 176 3/8")

Foundation



Impregnated foundation beams				
Mark	Type	Profile	Count	Length
IFB1	IFB 70x40		1	64 5/8"
IFB2	IFB 70x40		5	170 1/2"
IFB3	IFB 70x40		4	87 3/8"
IFB4	IFB 70x40		1	42 7/8"
IFB5	IFB 70x40		1	107 1/2"

# Laker Shed 40 (107 7/8" x 176 3/8")

Floor Plan

① Baseboard

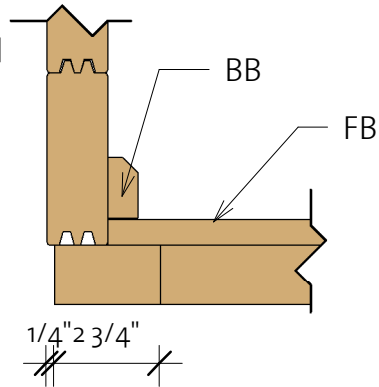

Floor Schedule				
Mark	Type	Profile	Count	Length
FB1	FB 17x114		20	61 5/8"
FB2	FB 17x114		21	104 1/2"
FB3	FB 17x114		15	83 1/8"
BB1	BB 20x40		2	189"
BB2	BB 20x40		2	169 1/4"
BB3	BB 20x40		2	118 1/8"

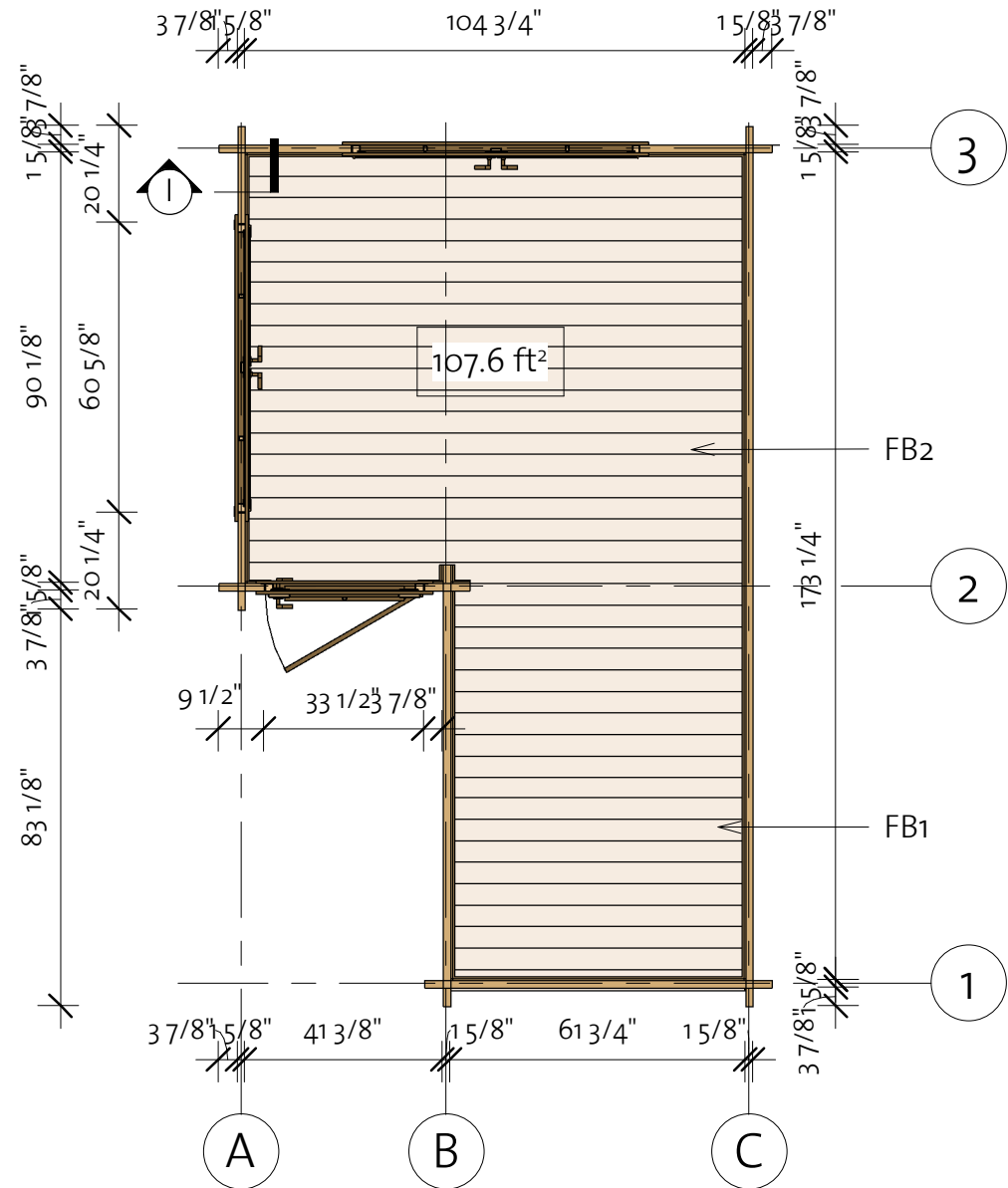



# Laker Shed 40 (107 7/8" x 176 3/8")

Wall 2

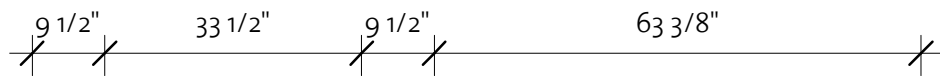
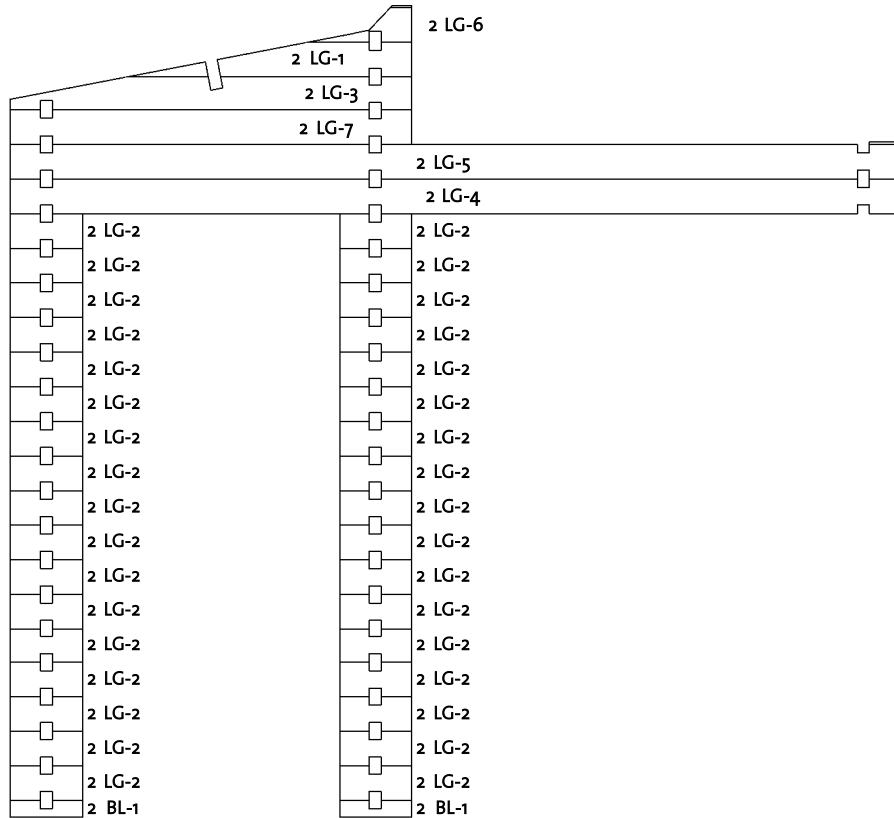
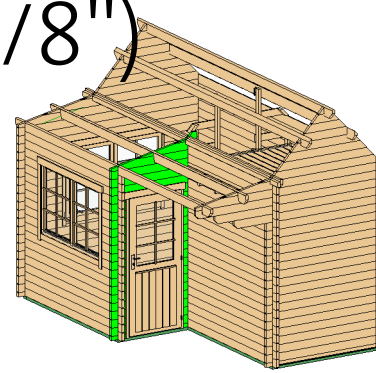

Wall 2			
Mark	Profile	Count	Cut Length

2BL-1	40X57	2	9 1/2"
2LG-1 *	40X114	1	37"
2LG-2	40X114	34	9 1/2"
2LG-3 *	40X114	1	52 3/8"
2LG-4	40X114	1	115 3/4"
2LG-5	40X114	1	115 3/4"
2LG-6 *	40X114	1	13 5/8"
2LG-7	40X114	1	52 3/8"

\* Gable - delivered premounted

Log Profile Wall 2

Profile

Profile

40X57



Log Profile Wall 2

Profile

Profile

40X114

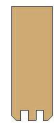

40X114

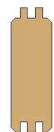

# Laker Shed 40 (107 7/8" x 176 3/8")

Wall 3

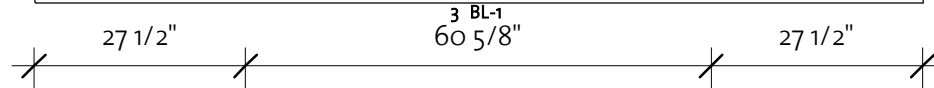
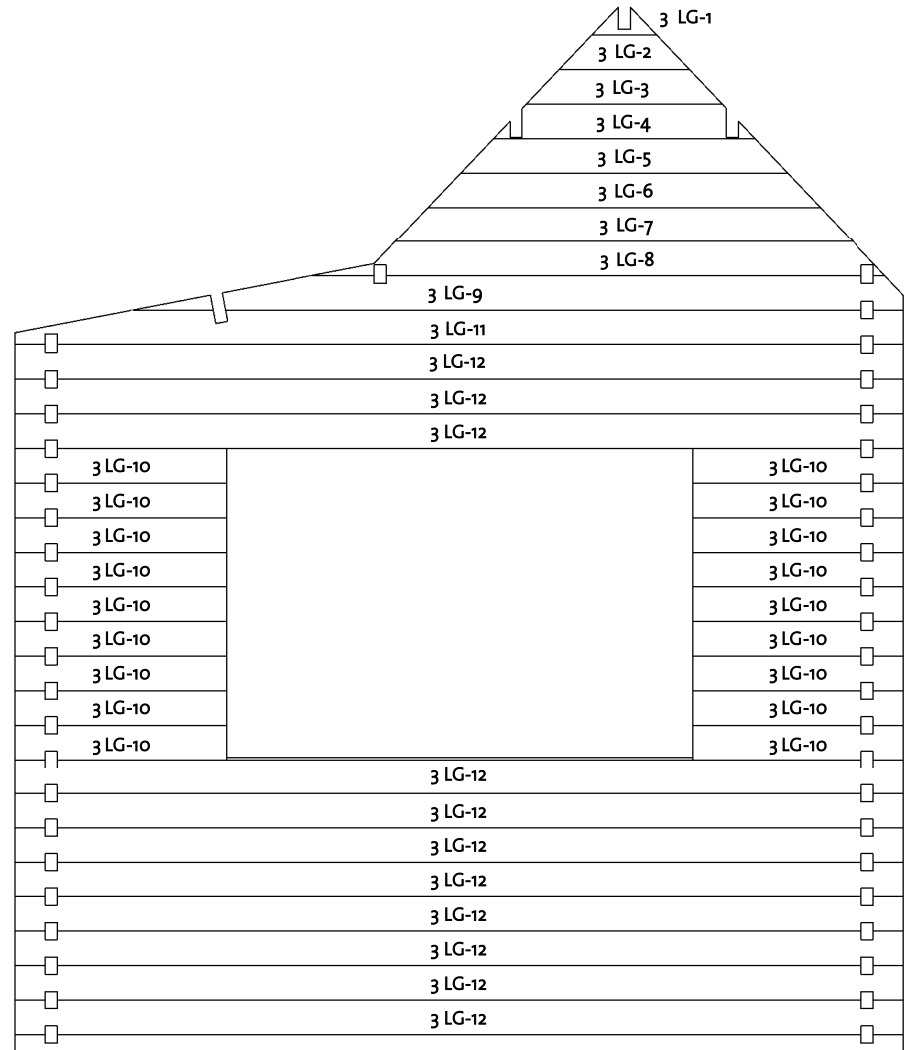
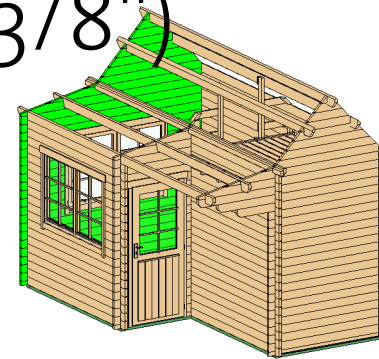

Wall 3			
Mark	Profile	Count	Cut Length

3BL-1	40X57	1	115 3/4"
3LG-1*	40X114	1	8 1/2"
3LG-2*	40X114	1	17"
3LG-3*	40X114	1	25 1/2"
3LG-4*	40X114	1	34"
3LG-5*	40X114	1	42 1/2"
3LG-6*	40X114	1	50 7/8"
3LG-7*	40X114	1	59 3/8"
3LG-8*	40X114	1	74 1/2"
3LG-9*	40X114	1	100 3/8"
3LG-10	40X114	18	27 1/2"
3LG-11*	40X114	1	115 3/4"
3LG-12	40X114	11	115 3/4"

\* Gable - delivered premounted

Log Profile Wall 3	
Profile	Profile

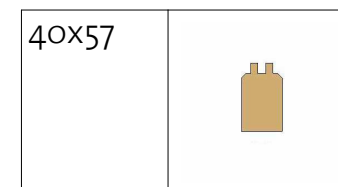

Log Profile Wall 3	
Profile	Profile

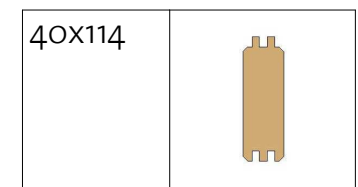

# Laker Shed 40 (107 7/8" x 176 3/8")

Wall A

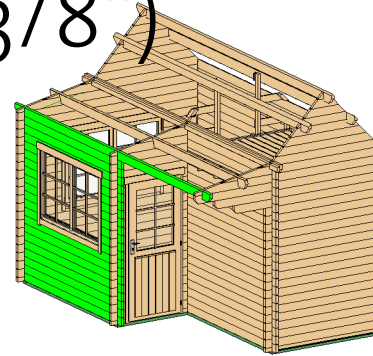

Wall A			
Mark	Profile	Count	Cut Length

ALG-1	40X114	16	20 1/4"
ALG-2	40X114	10	101 1/8"
ALG-3	40X114	1	101 1/8"
ALG-4	40X114	1	101 1/8"
ATL-1	40X123	1	192 1/8"

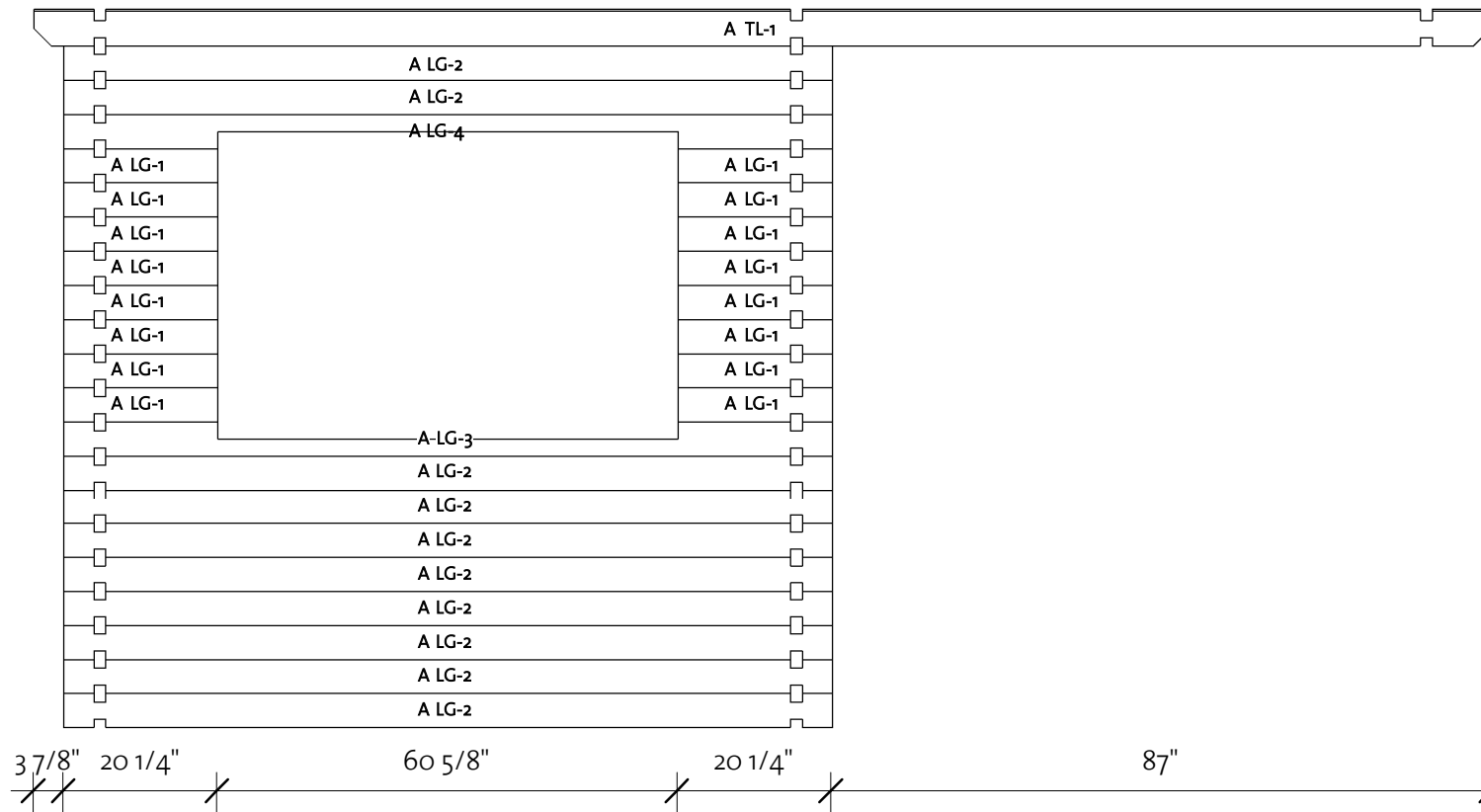

Log Profile Wall A	
Profile	Profile

40X114	
40X123	









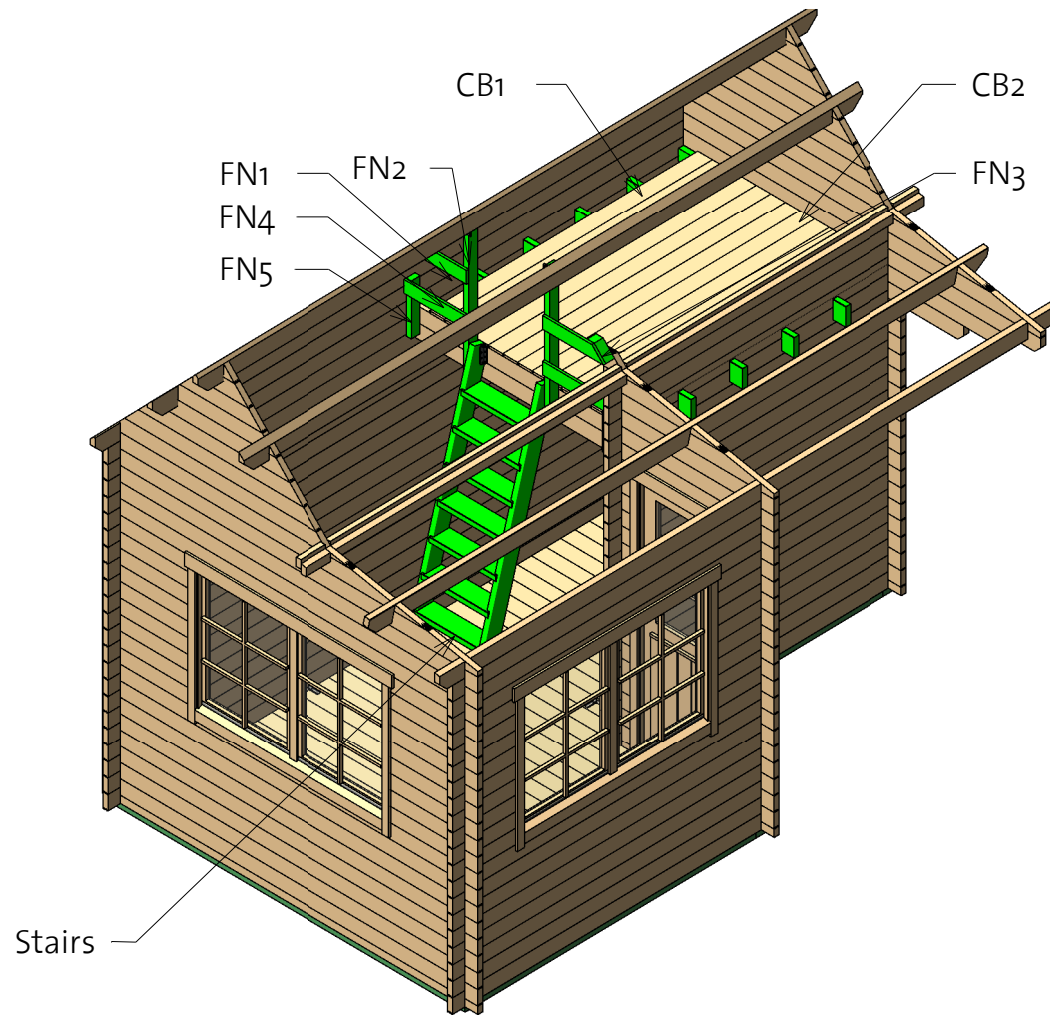

# Laker Shed 40 (107 7/8" x 176 3/8")

Second floor



Second floor				
Mark	Type	Profile	Count	Cut Length

CB2	Ceiling beam 40x90		2	61 3/4"
CB1	Ceiling beam 40x143		4	72 7/8"
FN1	Fence 18x95		2	18 3/4"
FN4	Fence 18x95		2	19 1/4"
FN2	Fence 40x70		2	41 3/8"
FN3	Fence 40x70		2	6 5/8"
FN5	Fence 40x70		2	15 3/4"

# Laker Shed 40 (107 7/8" x 176 3/8")

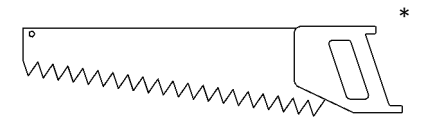
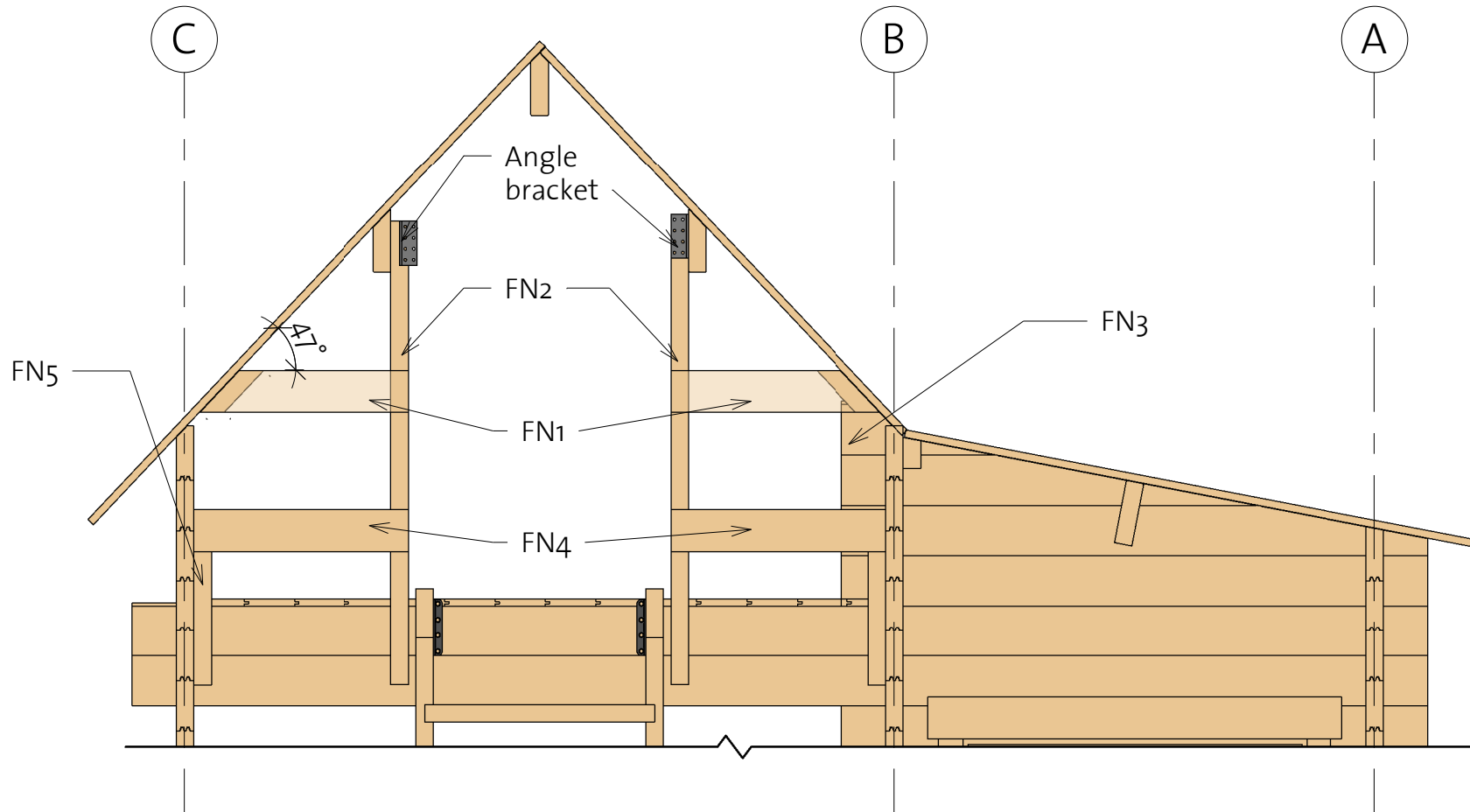

Fence

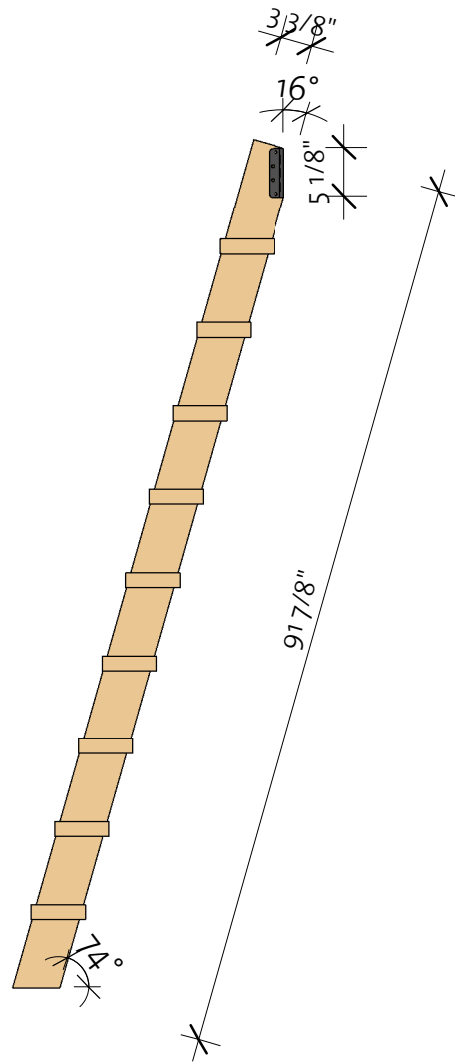
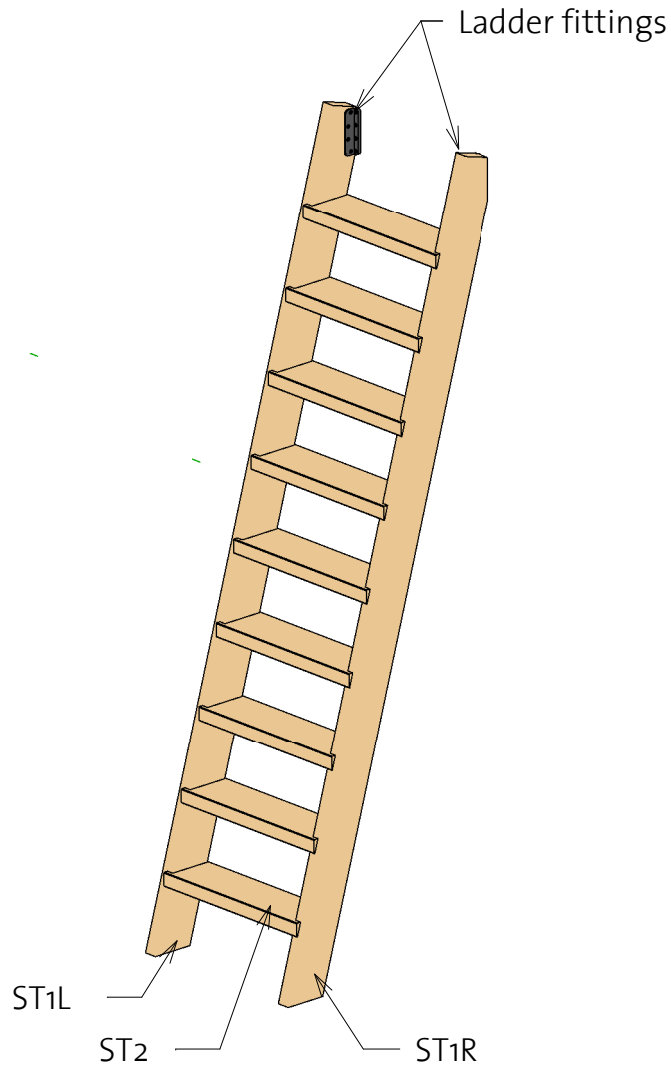

# Laker Shed 40 (107 7/8" x 176 3/8")

Stair



Stair				
Mark	Profile	Profile	Count	Cut Length
ST1R	Stair 40x120		1	91 7/8"
ST1L	Stair 40x120		1	91 7/8"
ST2	Stair 143x40		9	20 1/2"

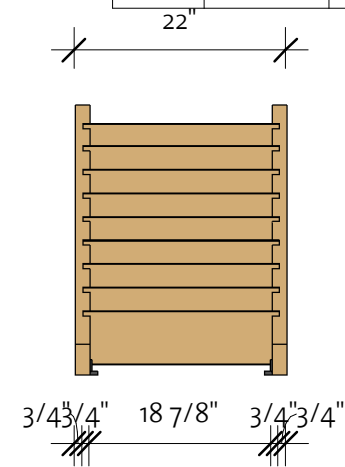

# Laker Shed 40 (107 7/8" x 176 3/8")

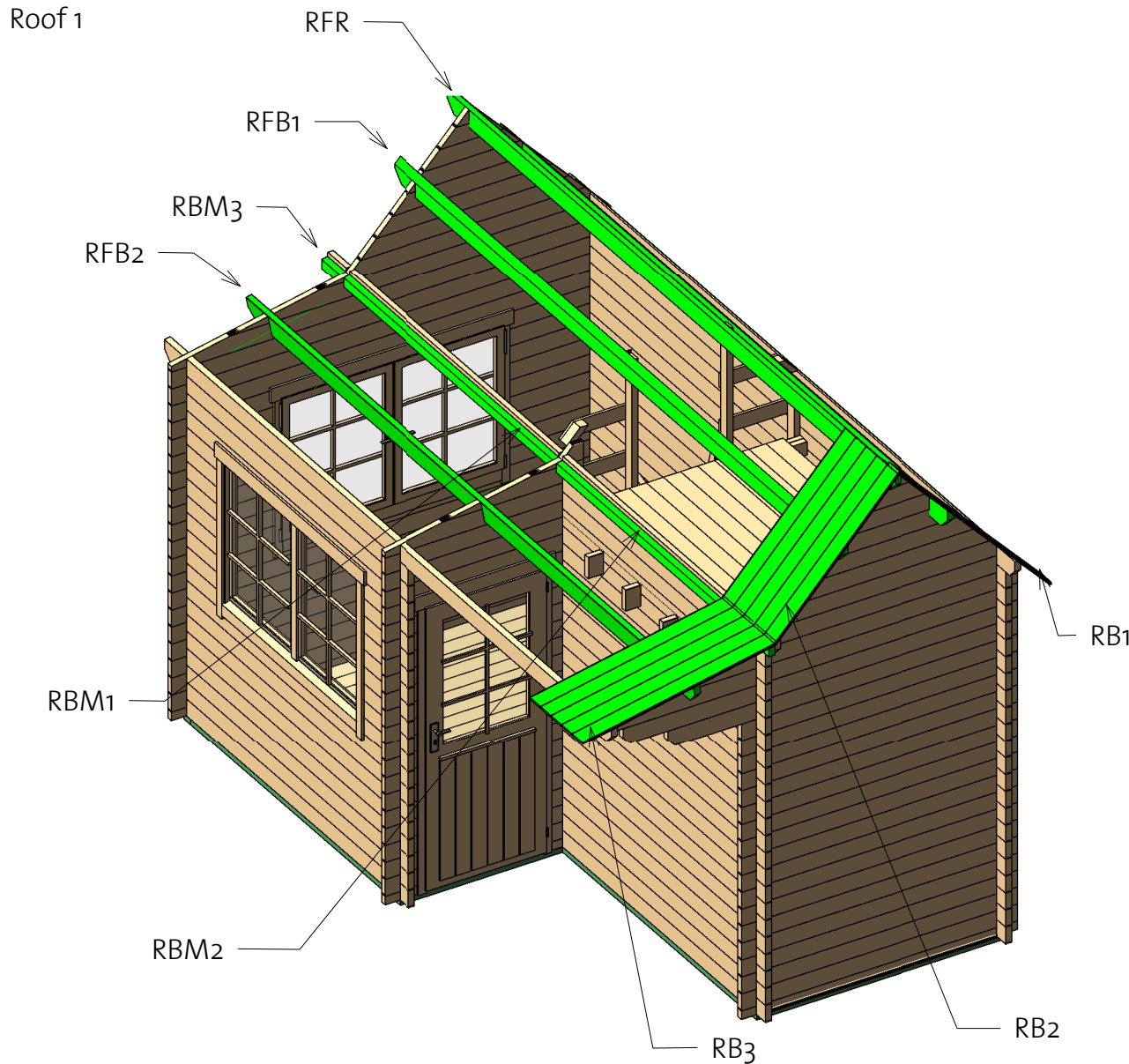

Roof				
Mark	Type	Profile	Count	Cut Length
RB1	17x114		44	58 3/4"
RB2	17x114		44	47"
RB3	17x114		44	51 1/2"
RBM1	Roof beam 40x70		1	90 1/8"
RBM2	Roof beam 40x70		1	81 1/2"
RBM3	Roof beam 40x70		1	7 7/8"
RBM4	Roof beam 40x70		1	7 7/8"
RFB1	Beam 40x143		2	192 1/8"
RFB2	Beam 40x143		1	192 1/8"
RFR	Ridge 40x143		1	192 1/8"

# Laker Shed 40 (107 7/8" x 176 3/8")

Roof 2

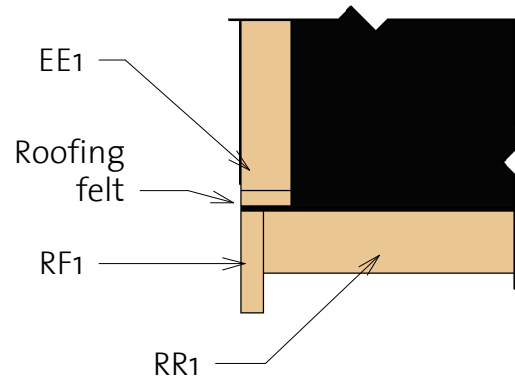
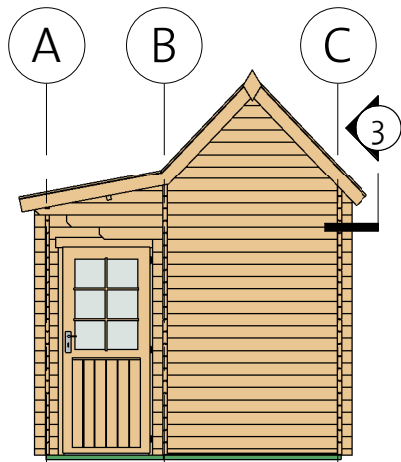
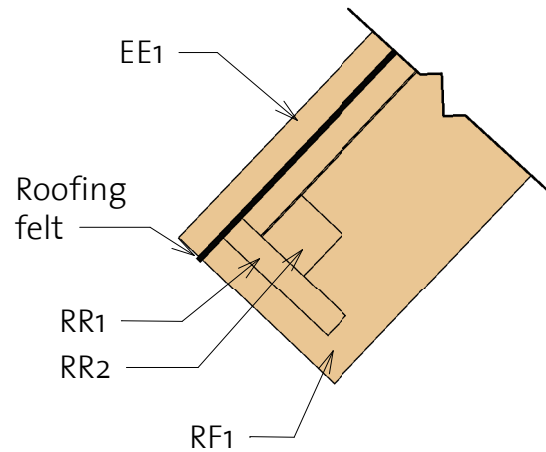
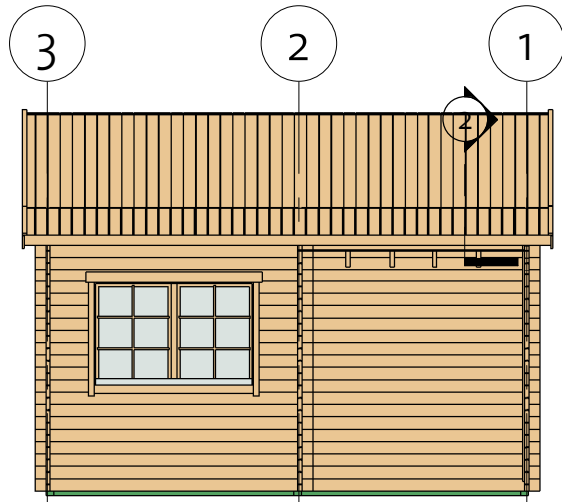

Fascia Schedule				
Mark	Type	Profile	Count	Length
EE1	Eave Edging 18x40		2	1530
EE2	Eave Edging 18x40		2	1237
EE3	Eave Edging 18x40		2	1342
RF1	Roof Fascia 18x120		2	1530
RF2	Roof Fascia 18x120		2	1253
RF3	Roof Fascia 18x120		2	1381
RR1	Roof reinforcement 18x95		2	4880
RR2	Roof reinforcement 38x38		2	4880

# Laker Shed 40 (107 7/8" x 176 3/8")

Extras



CD4R	Classic door 4 right	33 1/8"	77"	1
------	----------------------	---------	-----	---

DCB6	Door Crossbar 6	--	--	0"
------	-----------------	----	----	----

Window Schedule				
Mark	Type	Height	Width	Count

CDW1	Classic double window 1	39"	60 1/4"	2
------	-------------------------	-----	---------	---

WCB6	Windows Crossbar 6	--	--	4
------	--------------------	----	----	---

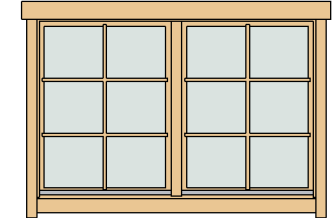

Fasteners/Extras		
Name	Type	Count

Hitblock	300-400 mm	
Ladder fittings		2
Angle bracket		2
Screws	5,0 x 40	12
Bolts	M8x70	15
Screws	5,0 x 70	70
Nails	1,4 x 40	70
Screws	6,0 x 140	120
Screws	4,0 x 40	1000



Type	Count
------	-------

Romb	2
------	---

Type	Count	Length
------	-------	--------



Windboard 18x40	5	104"
-----------------	---	------









# Laker Shed 40 (107 7/8"x176 3/8")

## List of all items 1

Impregnated foundation beams				
Mark	Type	Profile	Count	Length
IFB1	IFB 70x40		1	64 5/8"
IFB2	IFB 70x40		5	170 1/2"
IFB3	IFB 70x40		4	87 3/8"
IFB4	IFB 70x40		1	42 7/8"
IFB5	IFB 70x40		1	107 1/2"

Floor Schedule				
Mark	Type	Profile	Count	Length
FB1	FB 17x114		20	61 5/8"
FB2	FB 17x114		21	104 1/2"
FB3	FB 17x114		15	83 1/8"
BB1	BB 20x40		2	189"
BB2	BB 20x40		2	169 1/4"
BB3	BB 20x40		2	118 1/8"













Second floor				
Mark	Type	Profile	Count	Cut Length
CB2	Ceiling beam 40x90		2	61 3/4"
CB1	Ceiling beam 40x143		4	72 7/8"
FN1	Fence 18x95		2	18 3/4"
FN4	Fence 18x95		2	19 1/4"
FN2	Fence 40x70		2	41 3/8"
FN3	Fence 40x70		2	6 5/8"
FN5	Fence 40x70		2	15 3/4"

Stair				
Mark	Type	Profile	Count	Cut Length
ST1R	Stair 40x120		1	91 7/8"
ST1L	Stair 40x120		1	91 7/8"
ST2	Stair 143x40		9	20 1/2"

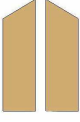

# Laker Shed 40 (107 7/8" x 176 3/8")

## List of all items 2

Roof					Fascia Schedule				
Mark	Type	Profile	Count	Cut Length	Mark	Type	Profile	Count	Length
RB1	17x114		44	58 3/4"	EE1	Eave Edging 18x40		2	1530
RB2	17x114		44	47"	EE2	Eave Edging 18x40		2	1237
RB3	17x114		44	51 1/2"	EE3	Eave Edging 18x40		2	1342
RBM1	Roof beam 40x70		1	90 1/8"	RF1	Roof Fascia 18x120		2	1530
RBM2	Roof beam 40x70		1	81 1/2"	RF2	Roof Fascia 18x120		2	1253
RBM3	Roof beam 40x70		1	77/8"	RF3	Roof Fascia 18x120		2	1381
RBM4	Roof beam 40x70		1	77/8"	RR1	Roof reinforcement 18x95		2	4880
RFB1	Beam 40x143		2	192 1/8"	RR2	Roof reinforcement 38x38		2	4880
RFB2	Beam 40x143		1	192 1/8"					
RFR	Ridge 40x143		1	192 1/8"					

# Laker Shed 40 (107 7/8"x176 3/8")

## List of all items 3

Wall 1			
Mark	Profile	Count	Cut Length

1BL-1	40x57	1	72 7/8"
1LG-1 *	40x114	1	8 1/2"
1LG-2 *	40x114	1	17"
1LG-3 *	40x114	1	25 1/2"
1LG-4 *	40x114	1	34"
1LG-5 *	40x114	1	42 1/2"
1LG-6 *	40x114	1	50 7/8"
1LG-7 *	40x114	1	59 3/8"
1LG-8 *	40x114	1	74 1/2"
1LG-9 *	40x114	1	100 3/8"
1LG-10	40x114	17	72 7/8"
1LG-11	40x114	1	92 1/8"
1LG-12	40x114	1	103 7/8"
1LG-13 *	40x114	1	115 3/4"
1LG-14	40x114	1	115 3/4"

\* Gable - delivered premounted

Wall 3			
Mark	Profile	Count	Cut Length

3BL-1	40x57	1	115 3/4"
3LG-1 *	40x114	1	8 1/2"
3LG-2 *	40x114	1	17"
3LG-3 *	40x114	1	25 1/2"
3LG-4 *	40x114	1	34"
3LG-5 *	40x114	1	42 1/2"
3LG-6 *	40x114	1	50 7/8"
3LG-7 *	40x114	1	59 3/8"
3LG-8 *	40x114	1	74 1/2"
3LG-9 *	40x114	1	100 3/8"
3LG-10	40x114	18	27 1/2"
3LG-11*	40x114	1	115 3/4"
3LG-12	40x114	11	115 3/4"

Wall 2			
Mark	Profile	Count	Cut Length

2BL-1	40x57	2	9 1/2"
2LG-1 *	40x114	1	37"
2LG-2	40x114	34	9 1/2"
2LG-3 *	40x114	1	52 3/8"
2LG-4	40x114	1	115 3/4"
2LG-5	40x114	1	115 3/4"
2LG-6 *	40x114	1	13 5/8"
2LG-7	40x114	1	52 3/8"

Wall A			
Mark	Profile	Count	Cut Length

ALG-1	40x114	16	20 1/4"
ALG-2	40x114	10	101 1/8"
ALG-3	40x114	1	101 1/8"
ALG-4	40x114	1	101 1/8"
ATL-1	40x123	1	192 1/8"

Wall B			
Mark	Profile	Count	Cut Length

BLG-1	40x114	20	92 1/2"
BLG-2	40x114	1	92 1/2"
BLG-3	40x114	1	92 1/2"
BTL-1	40x123	1	192 1/8"





# Laker Shed 40 (107 7/8"x176 3/8")

## List of all items 4

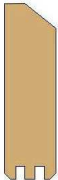
Wall C			
Mark	Profile	Count	Cut Length

CLG-1	40X114	19	184 1/4"
CLG-2	40X114	1	184 1/4"
CLG-3	40X114	1	184 1/4"
CLG-4	40X114	1	184 1/4"
CTL-1	40X123	1	192 1/8"

Log Profiles 1	
Profile	Profile
40X123	

Log profiles 2	
Profile	Profile
40X57	
40X114	
40X114	
40X123	
40X123	